

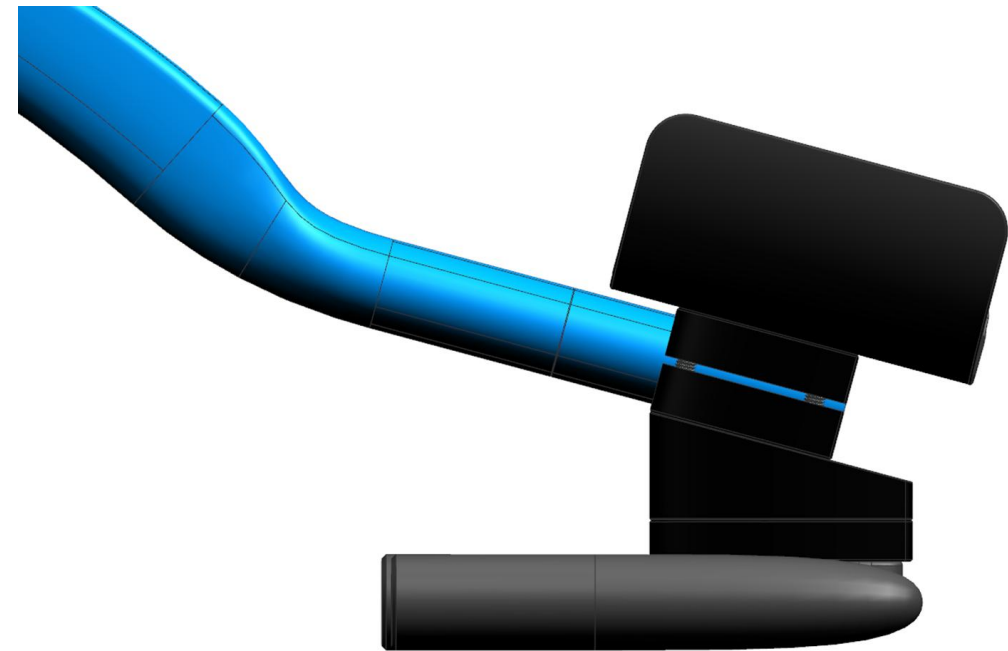

# Hi and Low Rise Pole fitting guide



1. Insert the pole into the pole clamp and determine where it needs to sit by looking at how much reach is needed



**DRAG2ZERO**

2. Ideally you want the kink in the pole to sit under the wrist

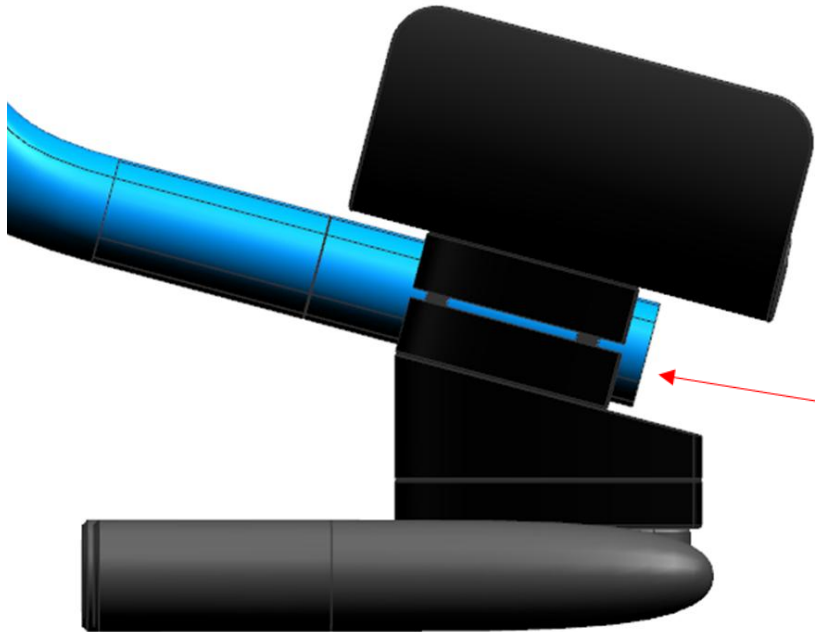
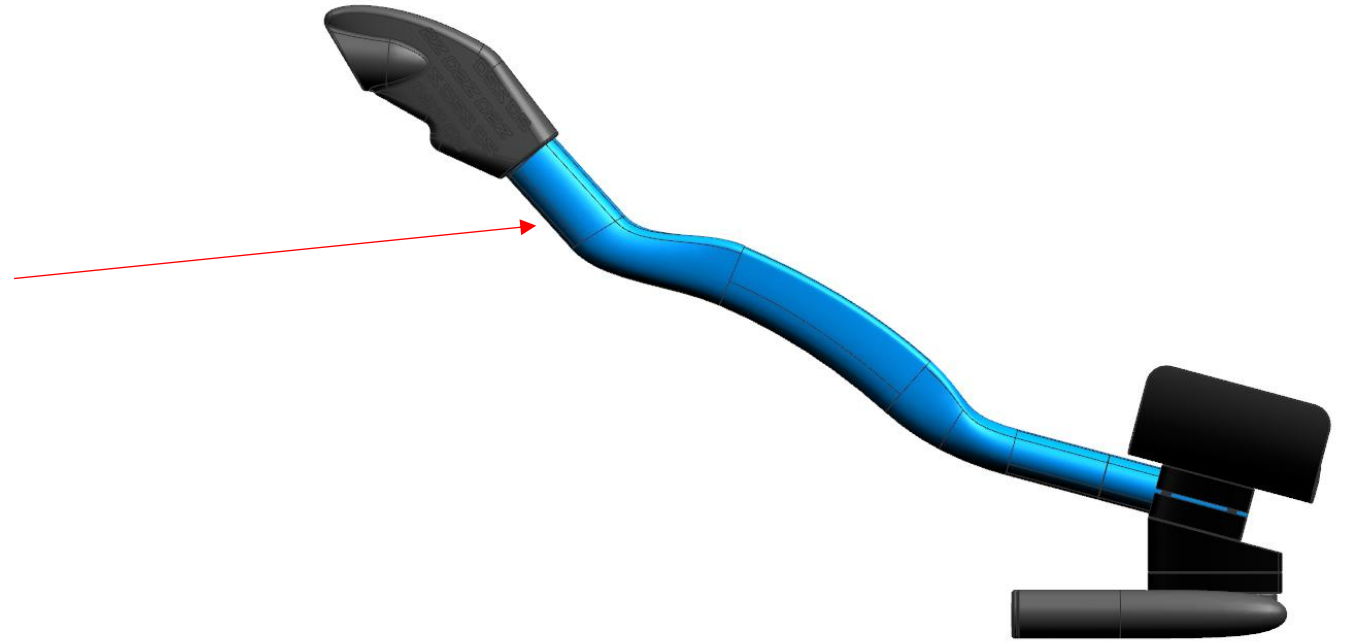

10mm clearance for D2Z pole clamp and fairing

3. If you are using a D2Z pole clamp and fairing, you should trim the pole (see next stage) to allow the pole to protrude 10mm from the back of the pole clamp so that the fairing may be attached onto it.

If you are using another proprietary pole clamp you can trim the back end of the pole so it is flush with your pole clamp.



**DRAG2ZERO**

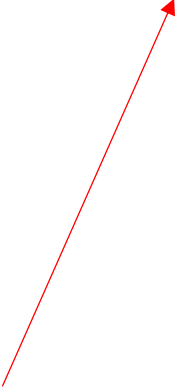

Make sure that your finger is able to reach and use the shifter on the end of the grip

If you can't reach the shifter when your wrist is in the kink, you will need to trim the end of the pole (see next stage)

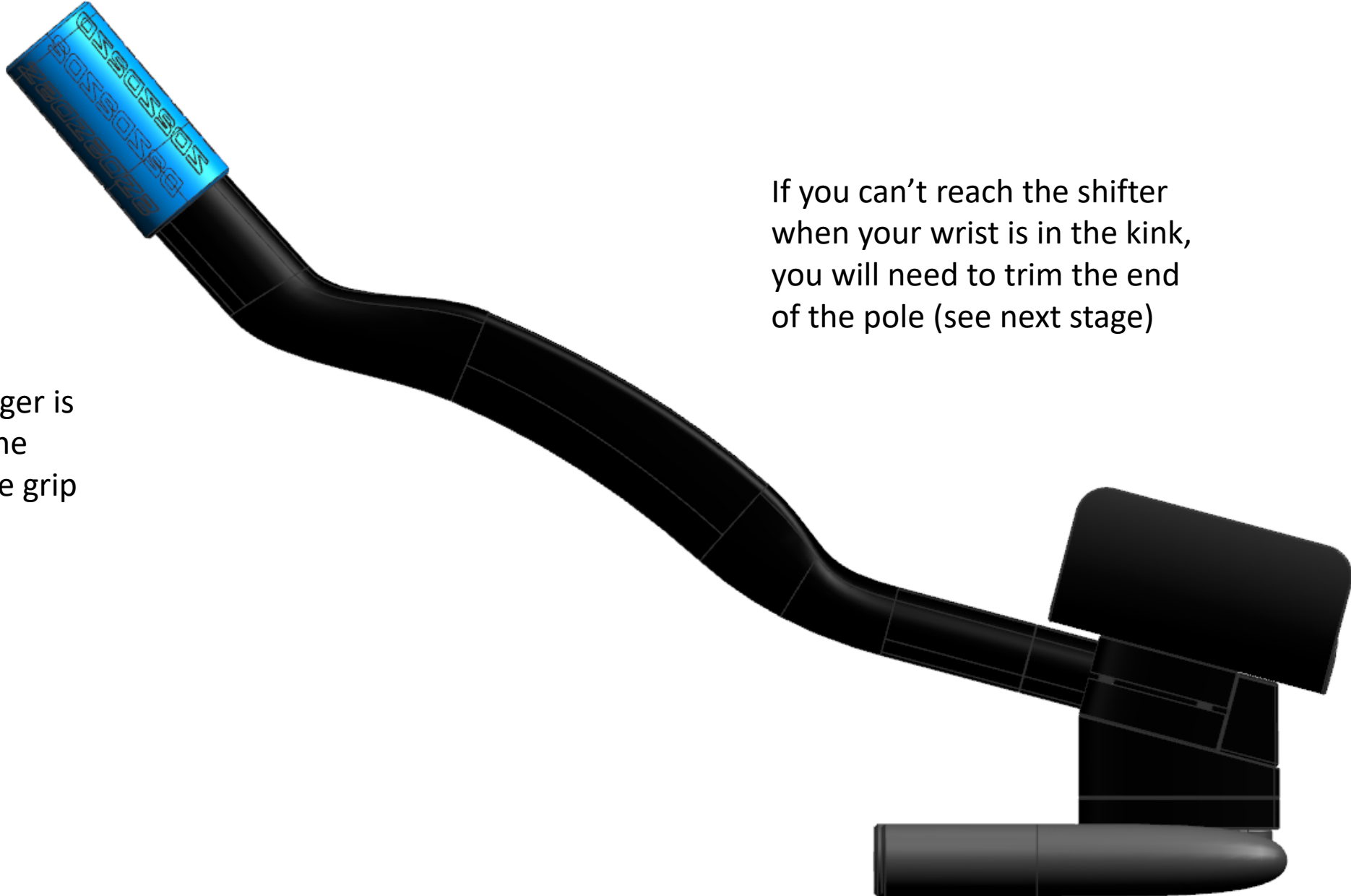

# Cutting boundaries

4. Once positioned correctly, mark where you need to trim.

You may trim the pole at both ends, if desired, up to the faint trim line that can be seen on both ends.

If you are not sure it is better to trim a smaller amount off first and then trim more if needed.

**Remember, measure twice, cut once!**

Do not cut beyond the trim lines

**Hi rise**

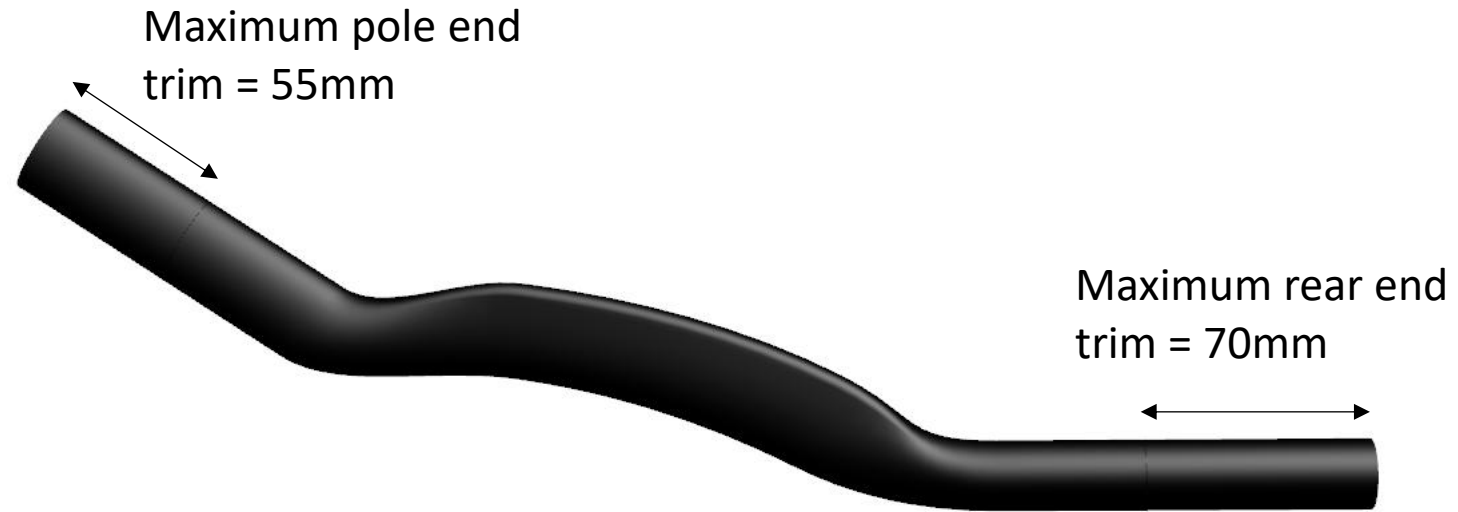

**Low rise**



# Adding a fairing

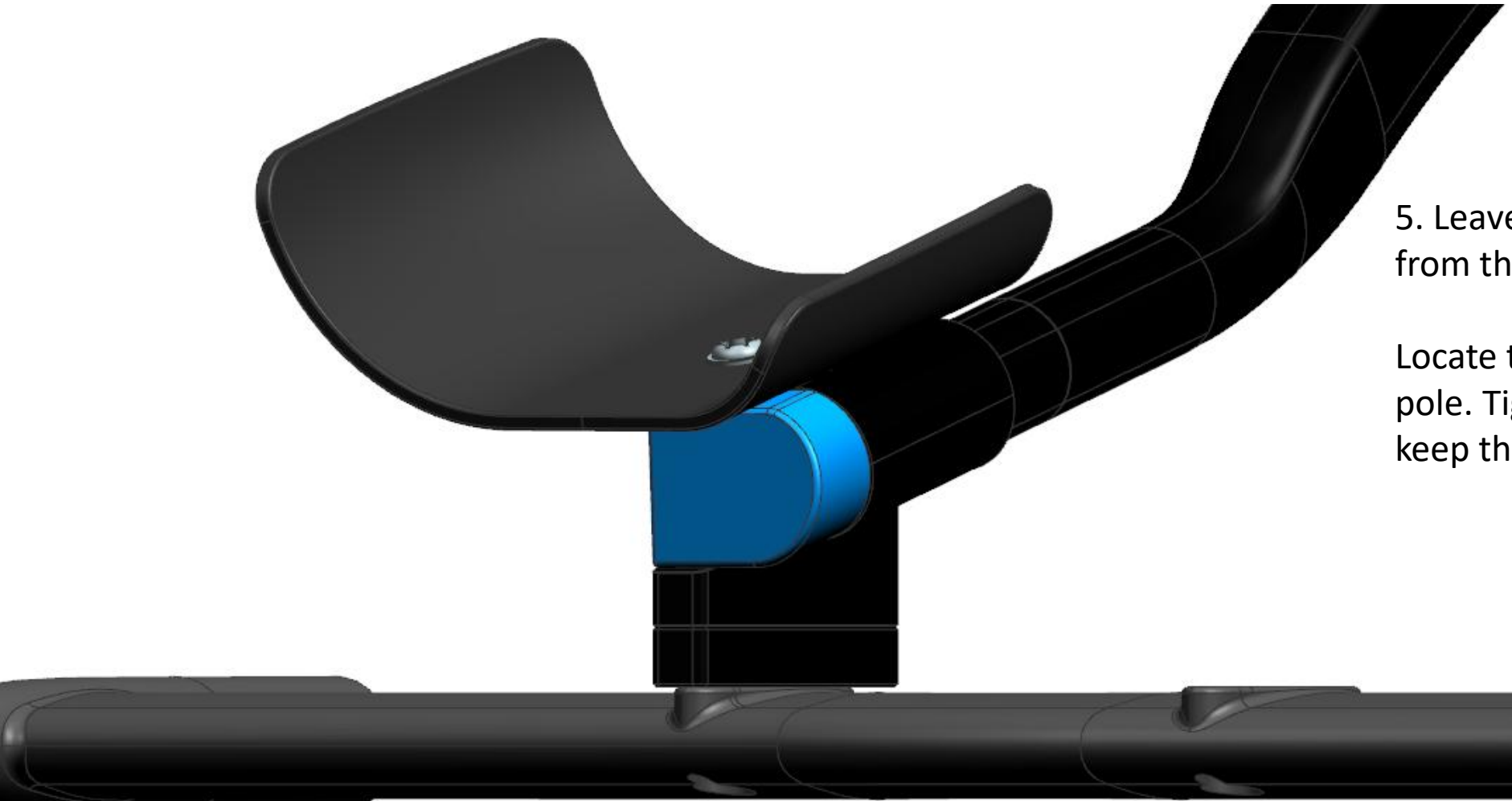

5. Leave 10mm of the pole protruding from the back of the clamp.

Locate the fairing onto the end of the pole. Tighten the pole clamp bolts to keep the fairing in place.



***DRAG2ZERO***

Drag2Zero Limited  
Silverstone Sports Engineering Hub  
Unit 1129 Silverstone Park, Buckingham Road  
Silverstone, Northamptonshire, NN12 8FU, UK

Follow us on Twitter, Facebook, Instagram @drag2zero  
Tel: +44 (0)1295 236117  
Email: [info@drag2zero.com](mailto:info@drag2zero.com)

© Drag2Zero Limited 2020